

Features

1. Direct acting and hanging type, no sliding parts. Free of performance deterioration caused by wear of sliding parts and great durability.
2. Wetted parts are made of corrosion-resistant material to prevent rusty water.
3. Highly wear-resistance and durability of stainless steel made valve seat.
4. Closed structure keeps fluid inside even if the diaphragm is damaged or broken.
5. Horizontal or vertical piping is possible.
6. Suitable for potable water and flushing water.

Specifications

Model		GD-24
Application		Cold and hot water, Flushing water
Inlet pressure		0.2-1.6 MPa
Reduced pressure		0.05-0.55 MPa
Minimum differential pressure		0.05 MPa
Maximum pressure reduction ratio		10:1
Application temperature		5-80°C *
Material	Body	Cast bronze
	Valve	Bronze
	Valve disc	EPDM (WRAS approval)
	Valve seat	*** Stainless steel
	Diaphragm	EPDM (WRAS approval)
	Cap	Bronze
Plug		*** Stainless steel
Connection		JIS Rc screwed (Equivalent to BS21)

* Do not use the valve continuously at a temperature of 70°C or over.

All Stainless Steel Part comply to BSEN 10088-1 Grade 1.4401 (SS316)



· If a large capacity is required, valves can be installed in parallel.

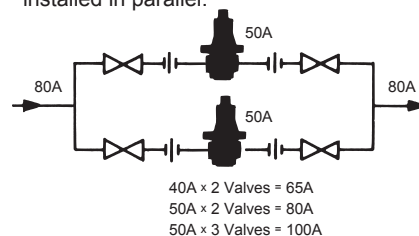

Dimensions (mm) and Weights (kg)

Nominal size	d	L	H	H ₁	Weight
15A	Rc 1/2	80	193	42	1.8
20A	Rc 3/4	90	210	45	2.4
25A	Rc 1	100	230	50	3.3
32A	Rc 1-1/4	120	265	60	4.7
40A	Rc 1-1/2	150	315	62	8.2
50A	Rc 2	185	365	73	14.3

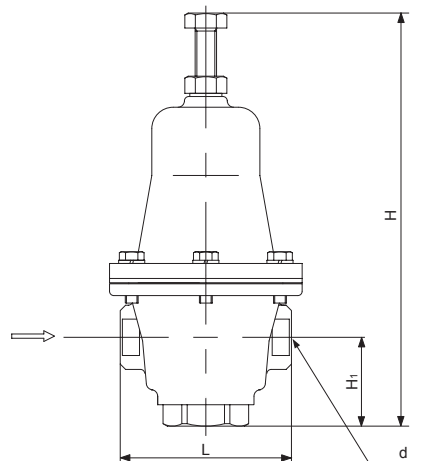

Nominal Sizes Selection Chart (For Water)

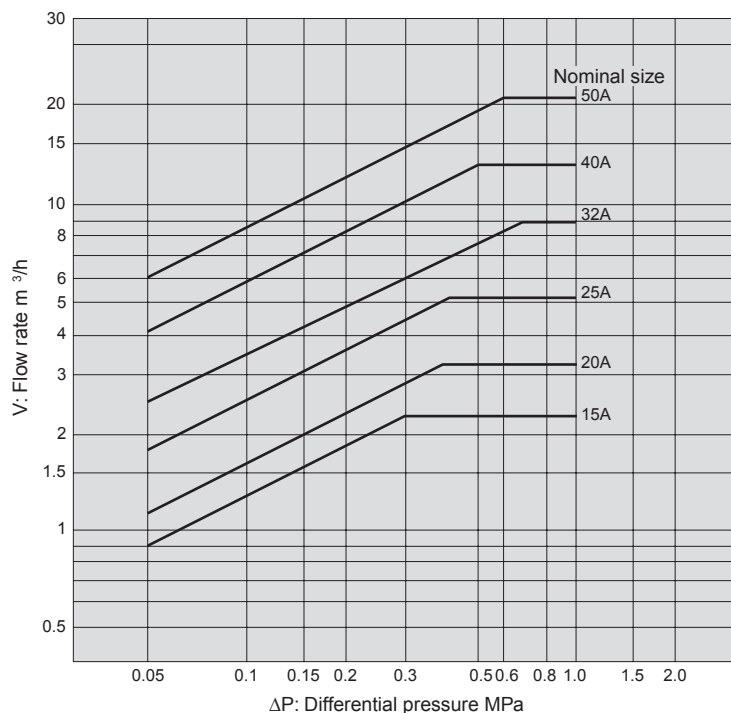

Flow Characteristic Chart

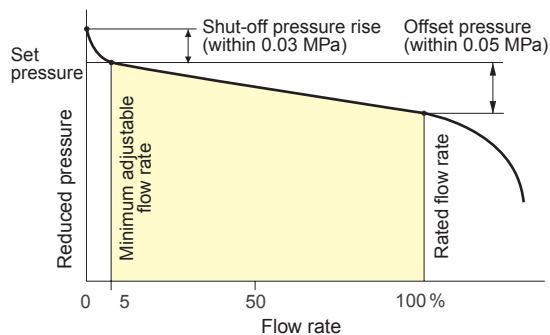

Pressure Characteristic Chart

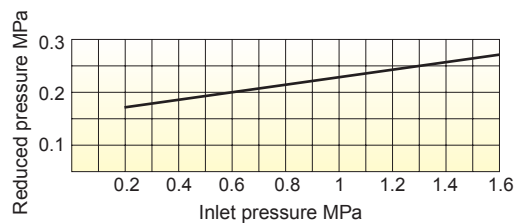

This chart shows variation in reduced pressure when the inlet pressure of 0.6 MPa is changed between 0.2 MPa and 1.6 MPa while the reduced pressure is set at 0.2 MPa.